



OPERATION MANUAL

●MOTORIZED SCREEN

Thank you for choosing our projection screen

Please read the manual carefully before using



ISO9001 2000 ISO14000

Thank you for choosing our screens

All the screens have passed the strict quality inspection before delivery
Read this manual carefully to ensure proper usage. You may also find the solution if you have problems.

Attention the installation of the screen is important, the electric connections, the setting of the limit switches, must be made from skilled engineer only

MOTORIZED SCREEN

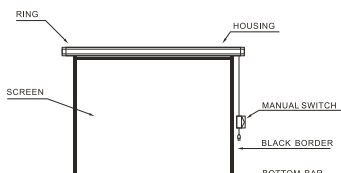

motorized screen with manual switch.

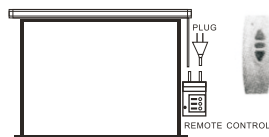

motorized screen with remote control.

1. CIRCUIT DIAGRAMS

If the motorized screen work with manual switch ,please refer to the below fig for electric connection.

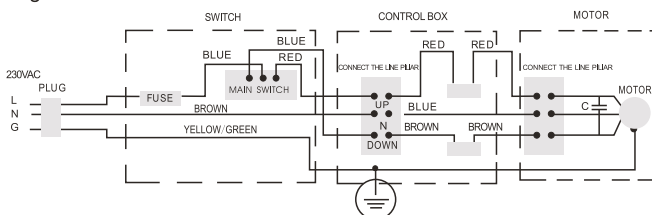

If the motorized screen work with remote control, please refer to the below fig for electric connection.

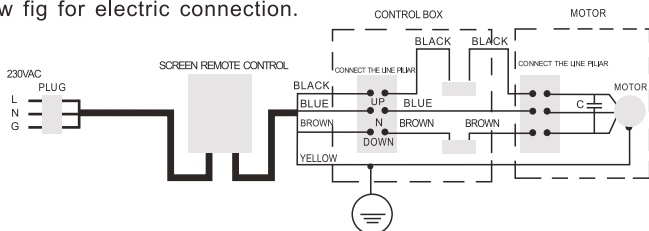

If the remote control does not work well, please check the battery and replace new one.

2. ADJUST LIMIT SWITCH

Adjust position for the two limit journey, refer to below picture:

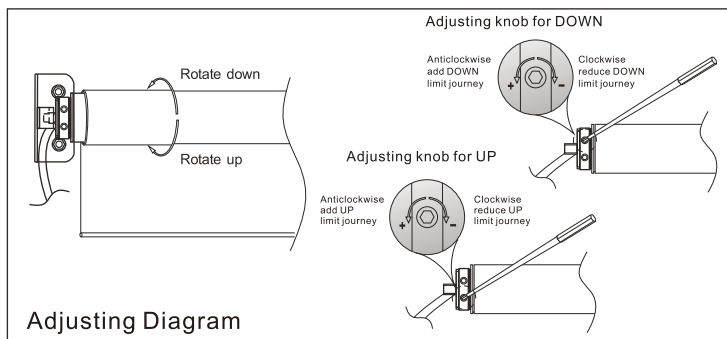

3. USEFUL INSTRUCTIONS

a. The screen should be switched to a suitable power supply. it can be 220V / 50HZ, 230V / 50HZ, or 110V / 60HZ, 120V / 60HZ, but the motor's power must be same as the local voltage and frequency.

b. The screen can be used with or without the remote controller. The remote control system can be radio type or infrared type, normally if a remote control system needed, a radio remote controller is supplied but an infrared type controller is also available for a special requirement these two different controlling functions can not combined in one control system.

c. Normally a synchronized motor is installed inside the housing but a tubular motor is also available for a special requirement.

d. If the remote control system is not accompanied, the screen can Operated by the control box directly, just push the UP/ DOWN / STOP button on the control box and operate the screen. Or the screen can be operated by the remote controller.

e. The screen will automatically stops when the screen fabric goes up and back to the housing or when the top black border comes out totally. The screen can also stop at any position which you want.

4. INSTALLING

- a. Unpack the screen carefully, be sure the screen is in good condition, check all the accessories are packed inside the carton.
- b. Check the voltage and frequency marked on the screen is in accordance with the local power supply. It is suggested only to use the screens indoor under normal temperature and humidity.
- c. Refer to the below fig and fix the screen to the wall or to the ceiling.

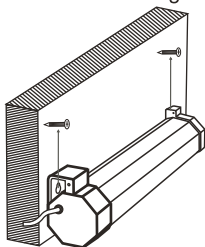

fix the screen to the wall.

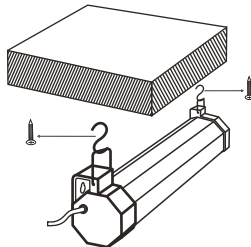

fix the screen to the ceiling.

- d. Plug in the power supply. Press the down button of the manual switch or the transmitter, the screen will go down smoothly. Press the stop button when the screen goes down to the expected position, otherwise the screen will stop at the lower limited position automatically.



- e. Press the up button of the manual switch or the transmitter, the screen will go up smoothly. Press the stop button when the screen goes up to the expected position, otherwise the screen will roll back to the housing.

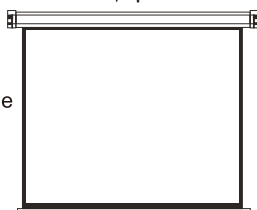

The screen won't be used for a long time when you cut off the power supply.

Don not pull the control wires to avoid disconnection and it's dangerous.

- f. Moving Parts of the drive must be installed higher than 2,5 mm above the floor or other level that could provide access to it.

5 WARNINGS

a. The screen can not be folded. Do not use fingers or hard objects to touch the screen surface. Do not splash the milk, fruit juice or other chemical doses to the screen surface. Keep the screen far away from the high temperature objects or fire.

b. If the screen is dirty, wash the screen gently by a broom or a cotton ball, do not use the organic solvents to clean the screen surface.

c. When pulling the screen down, must be slowly and vertical. Do not pull it roughly. Please stop pulling as soon as the black border is out or the screen is jammed or injured, then send the screen to the maintenance center.

d. After using, put the screen back to the housing in order to avoid being polluted. If not using it for a long time, please take the screen from the wall and pack it in a carton.

e. If the power soft cable was broken, you have to replace it by technical people from the manufacturer or service department ensure safety.

WARNINGS Important safety instructions. It is important for the safety of persons to follow these instructions. Save these instructions.

- do not allow children to play with fixed controls. Keep remote controls away from children;

- Frequently examine the installation for imbalance and signs of wear or damage to cables and springs.

Do not use if repair or adjustment is necessary;

If the supply cord is damaged, it must be replaced by the manufacturer, its service agent or similarly qualified persons in order to avoid a hazard.

This appliance is not intended for use by persons (including children) with reduced physical, sensory or mental capabilities, or lack of experience and knowledge, unless they have been given supervision or instruction concerning use of the appliance by a person responsible for their safety.

Children should be supervised to ensure that they do not play with the appliance.

6. REMOTE CONTROL SYSTEM

1. The remote control can be IR Type or RF Type.

2. (A-IR Type) Plug in the power cable for the controller. The power source indicator will flash. After the stop button of the remote control is pressed and either the up or down button is pressed again, the power relay of the controller will start to operate. Press the stop button after eight seconds, the power source indicator will stop flashing. This is evidence that the controller has finished automatic learning successfully. Above operation is normally completed in eight seconds.

(B-RF Type) Press the down button, then plug in the power source indicator will flash. After the stop button of the remote control is pressed. The down button is pressed again, the power relay of the controller will start to operate. Press the stop button, after eight seconds, the power source indicator will stop flashing. This is evidence that the controller has finished automatic learning successfully. Above operation is normally completed in eight seconds.

3. When the up and down buttons are pressed in the same time, the remote control is locked. Operation will be stopped. The system will be unlocked if the stop button is pressed again.
4. The power source will be cut off automatically if the motor operation has passed the preset time limit. Then the motor will stop operation.
5. The motor will perform up functions if the up button of the controller is pressed. If the stop button or down button is pressed, the motor will stop operation. When down button is pressed again, the motor will perform down functions. In case stop or up button is pressed, the motor will stop operation.

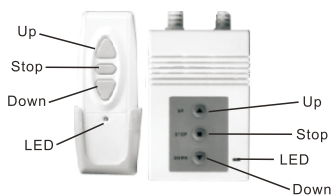

RF Type